



MINI CHILLER

Monobloc air cooled chillers



- **Compact dimensions**
- **Efficient and suitable also for processing activities**
- **Easy to install and to use**

The MINI CHILLER is an air cooled water chiller. The unit is equipped with hydronic kit provided plant side and uses a new regulation device that allows optimal operation of the unit. The hydronic kit, ready to use, facilitates the installation operations, reducing its spaces and the related costs. In addition, it avoids useless heat dispersion towards the outside.

Invented an designed for industrial application "open vessel", the unit is very adaptable to the movement, considering its compact dimensions and the presence of pivotal wheels.

A system specifically studied for this type of application, which involves the evaporator immersed inside the tank, guarantees the highest level of efficiency reducing considerably the heat dispersions towards the outside and, at the same time, gives more stability to the temperature of the process fluid.

The units are mounted on selfsupporting frame galvanised steel made complete with removable paneling, entirely painted with stovedried polyester powder colour RAL 9018.

Rotary hermetic compressor of a leading brand, able to ensure high efficiency and, at the same time, a low noise and vibration level, with refrigerant R410A. Installed on anti-vibration supports and provided with heat protection to protect the motor.

Accessories

Air filter kit
Basament wheels kit
Modulating fan speed control

MINI CHILLER		UNITS OF MEASURE	
Unit performance - Chiller	Cooling capacity	kW	4
	Refrigerant Circuits	n°	1
	Steps	n°	1
	Power supply	V / Ph /Hz	230 / 1 / 50
	Outside air temperature	°C	35
	Refrigerant	-	R410A
	In fluid temperature	°C	15
	Out fluid temperature	°C	10
Operating limits	Outdoor air temperatur *	°C	+10 / 40
	Chilled water temperature	°C	5 / 15
Compressor	Number of compressors	n°	1
	Unit power input	kW	1,4
	Unit current input	A	6,3
	Max current	A	6,8
	Current at start	A	37
Evaporator	Type exchangers	-	Brazed plate
	Number exchangers	n°	1
	Fluid flow	l/s	0,192
Condenser	Type exchangers	-	Finned coils
Spiral fan	Number fans	n°	1
	Air flow	m³/s	0,53
	Unit power input	kW	0,12
	Unit current input	A	0,51
Hydronic kit	Wet rotor circulator	n°	1
	Available pressure	kPa	320
	Unit power input	kW	0,5
Total power with pump	Nominal input power	kW	2,02
	Nominal current	A	9,81
	Current Max	A	10,8
	Current at start	A	40,41
Sizes	Length	mm	750
	Width	mm	550
	Height	mm	900
	Hydraulic connections diameter	mm	M 3/4" G

Technical Drawings

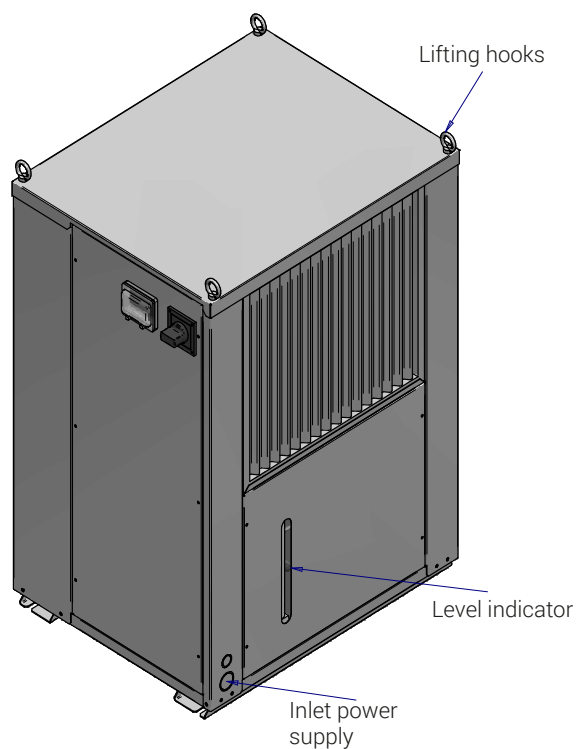
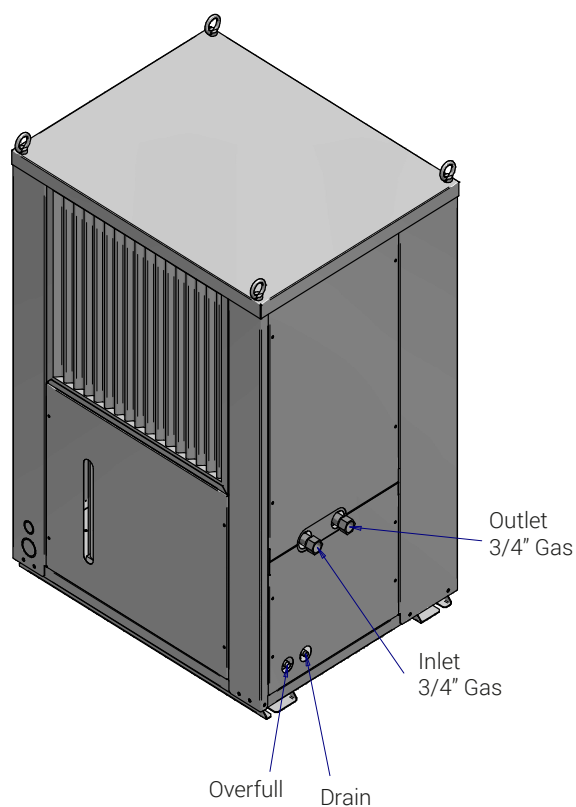
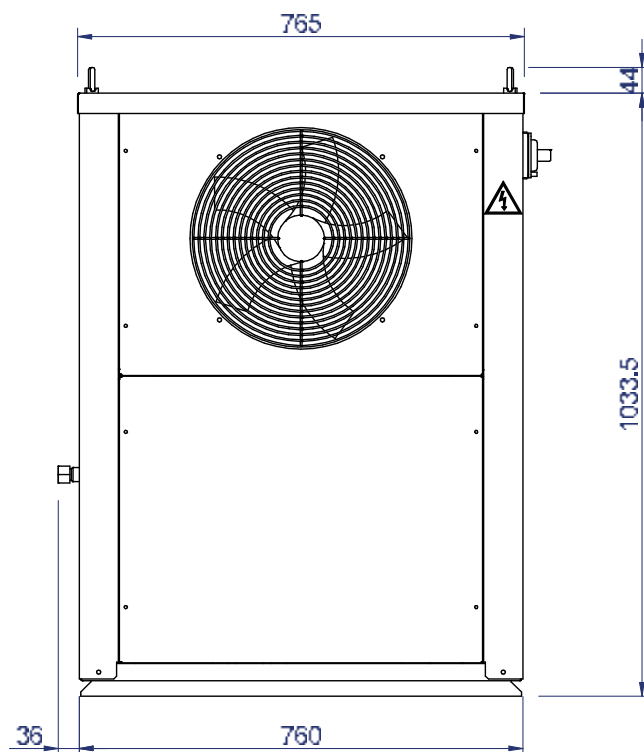
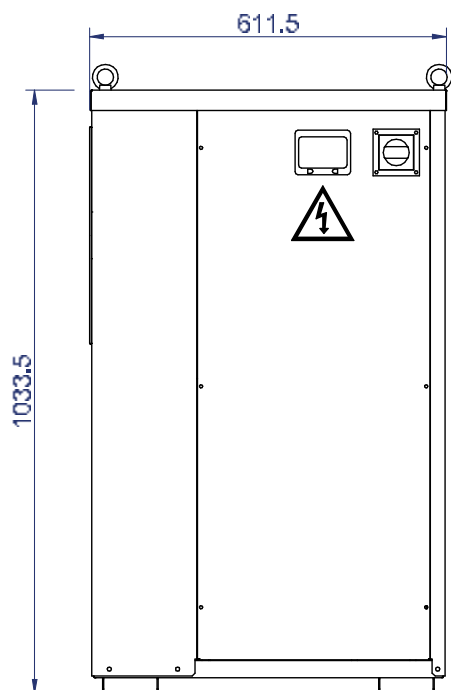

POSITION OF THE ANTI-VIBRANT SUPPORTS

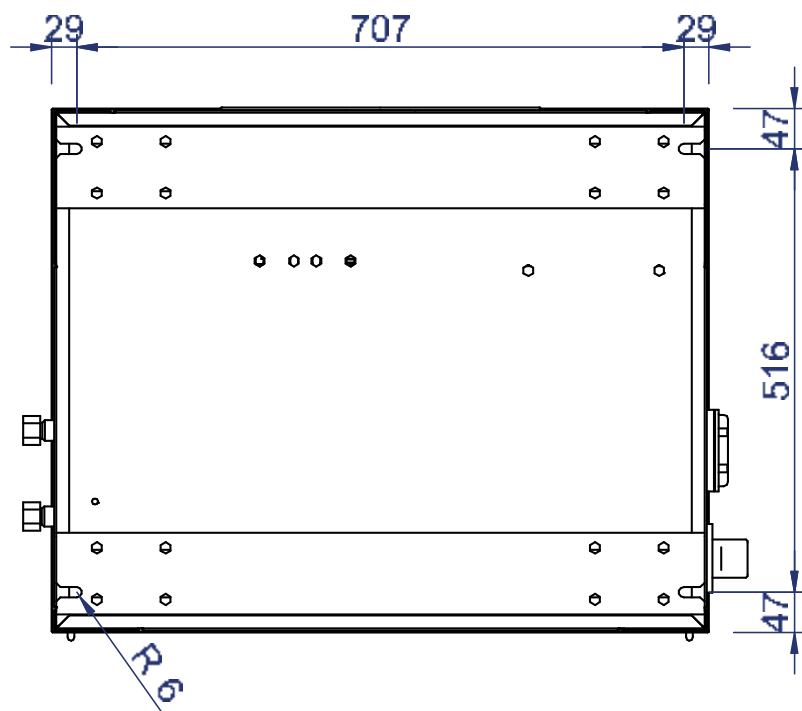

STRUCTURE SUPPORT WITH WHEELS (OPTIONAL ACCESSORY)

